

# Bravo 2 Instructions

---

## Removing or Inserting the Lenses

To Remove the Lenses:

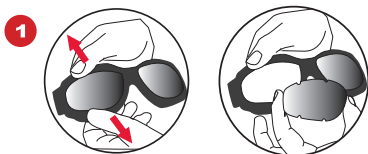

Grasp frame from top and bottom for each individual lens. Pull apart to release seal from lens. Push lens from the inside out to remove.

To Insert the Lenses:

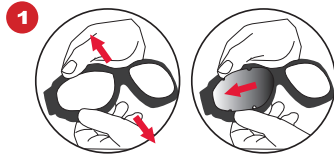

Pull top and bottom of frame in opposite direction while sliding in the outer most corner of the lens. From there pull the top part of the frame to secure the top part of the lens, then the nose piece to secure the corner of the lens, then the bottom. Push tightly to ensure proper fit.

---

## Inserting the RX Insert:

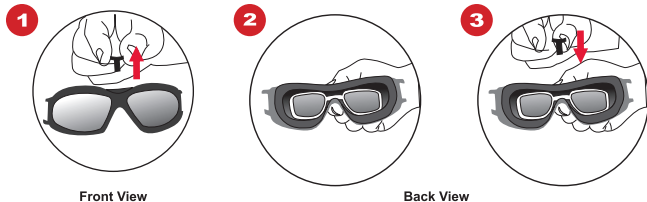

Front View

Back View

Lift T tab on the top of the frame, push insert into the frame until secure and place T tab back into the frame.